

Superjaws - SJA001

Portable workstation / vice. Introduced January 1992.

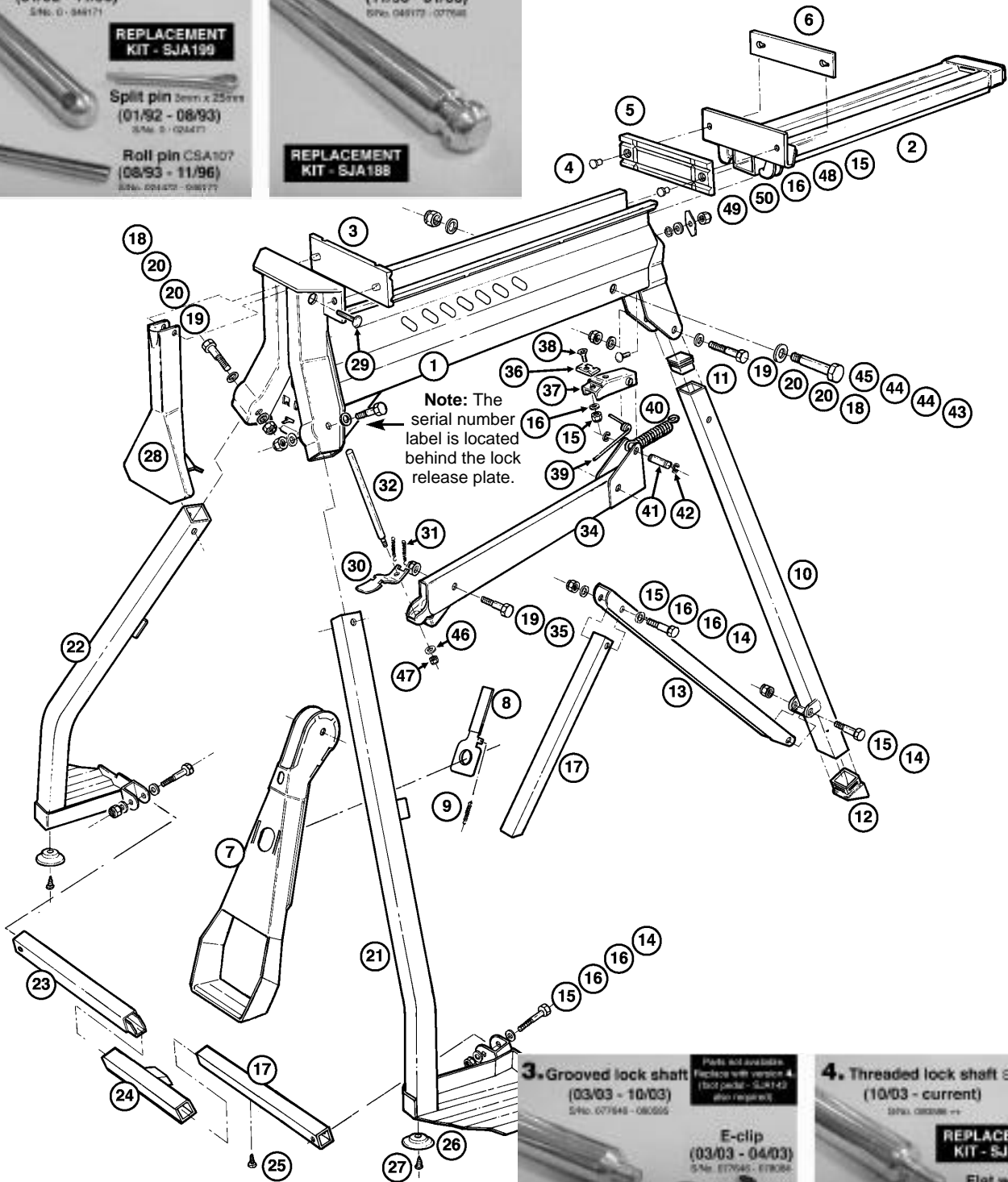

- Earlier model Superjaws differ slightly to the above diagram. The improvements and dates of change are:
1. A urethane jaw facing (3) was fitted to the rear of the moving jaw. From 1/9/94 - Serial Number 32675
 2. The main body (1) had angled slots pierced in the sides. From 1/12/93 - Serial Number 27581
 3. The pedal lock ring (8) was fitted to the rear of the foot pedal. (This part cannot be fitted to earlier pedal assemblies). From 23/3/95 - Serial Number 36929
 4. Rubber feet were added (27). From 1/6/94 - Serial Number 30074
 5. The lock shaft has had several versions - refer to the above illustrations for details of all versions.

Superjaws - SJA001

Portable workstation / vice. Introduced January 1992.

Ref. Part No.	Description	Ref. Part No.	Description
1 SJA003	Main Body	29 CSA160	Headed Pin
2 SJA022	Sliding Jaw	30 SJA057	Lock Pawl
3 SJA027	Urethane Facing (Front Jaw)	31 SJA059	Lock Pawl Spring
4 SJA136	Locating Pins	32 SJA195	Lock Shaft (s/n 80586 onward)
5 SJA129	Urethane Facing (Sliding Jaw)	SJA188	Lock shaft repair kit (s/n 46172 - 77645)
6 SJA127	Rear Urethane Facing (Sliding Jaw)		(includes parts 30, 31, 32)
SJA189	Replacement urethane jaw facings kit (parts 3, 4, 5, 6)	SJA050	Lock shaft (up to s/no. 046171)
7 SJA142	Foot Pedal	SJA186	Lock shaft (s/no. 046172 - 077645)
8 SJA140	Foot Pedal Lock Bar	SJA196	Lock shaft repair kit (s/n 80586 onward)
9 SJA141	Foot Pedal Lock Bar Spring		- also suits s/no.77646 - 80585 with replacement foot pedal (SJA142).
10 SJA064	Rear Leg	SJA199	Lock shaft repair kit (up to s/n 46171)
11 CPA013	Tube Closer, Flat	34 SJA029	Pedal Arm
12 SJE006	Tube Closer, Angled	35 CSA097	M8 x 35mm Bolt
13 SJA069	Leg Spreader Channel	36 SJA043	Drive Pawl
14 CSA100	M6 x 40mm Bolt	37 SJA040	Pawl Carrier
15 CSA090	M6 Nyloc Nut	38 CSA087	Countersunk Bolt
16 CSA025	1/4 x 1/2 Flat Washer	39 SJA045	Pawl Carrier Spring
17 SJA154	Rear Leg Spreader	40 SJA046	Pedal Return Spring
18 CSA101	M8 x 45mm Bolt	41 SJA044	Pawl Carrier Pivot
19 CSA098	M8 Nyloc Nut	42 CSA091	Circlip
20 CSA099	M8 Flat Washer	43 CSA094	M12 x 65mm Bolt
21 SJA091	Front Leg, RH	44 CSA096	M12 Flat Washer
22 SJA074	Front Leg, LH	45 CSA095	M12 Nyloc Nut
23 SJA157	Front Leg Spreader	46 CSA260	M4 Washer
24 SJA161	Joiner	47 CSA156	M4 Nyloc Nut
25 CSA158	Stop Screw	48 SJA190	Jaw Catch
26 SJE007	Rubber Foot	49 CSA103	M6 x 16mm Coach Bolt
27 CSA136	Screw	50 CSA021	1/4 Spring Washer
28 SJA187	Lock-release Plate		

Specifications:

Packed weight: 21.90kg

Pack Size: 775 x 370 x 310mm **Volume:** 0.085m³

Paint:: Epoxy powder coat (oven cured) **Main Body:** Telecom Gold

Legs : Charcoal Grey

Cast Engineers Jaws (SJA118)

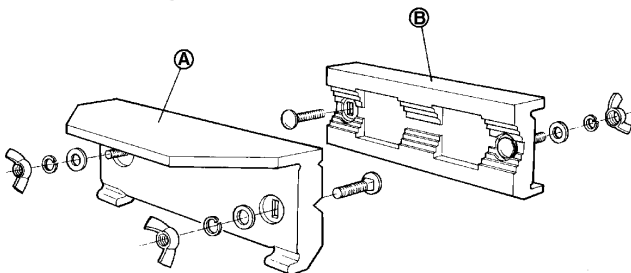

Ref. Part No.	Description
- PUA147	Packing Carton
A SJA119	Front Jaw with Anvil
B SJA121	Rear Jaw
- SJA133	Hardware Pack

Log & Pole Gripping Jaws (SJA130)

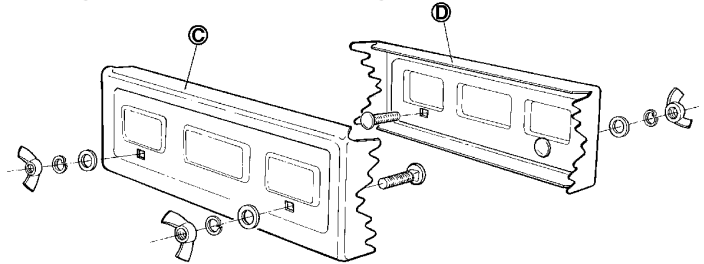

Ref. Part No.	Description
- PUA148	Packing Carton
C SJA131	Log Jaw
- SJA133	Hardware Pack

Specifications:

Packed Weight: 2.41kg

Pack Size: 194 x 74 x 72mm

Volume: 0.001m³

Specifications:

Packed Weight: 1.58kg

Pack Size: 268 x 107 x 43mm

Volume: 0.001m³