

# Jigsaw Kit - AJA300

Suits Router Table model RTA300 only

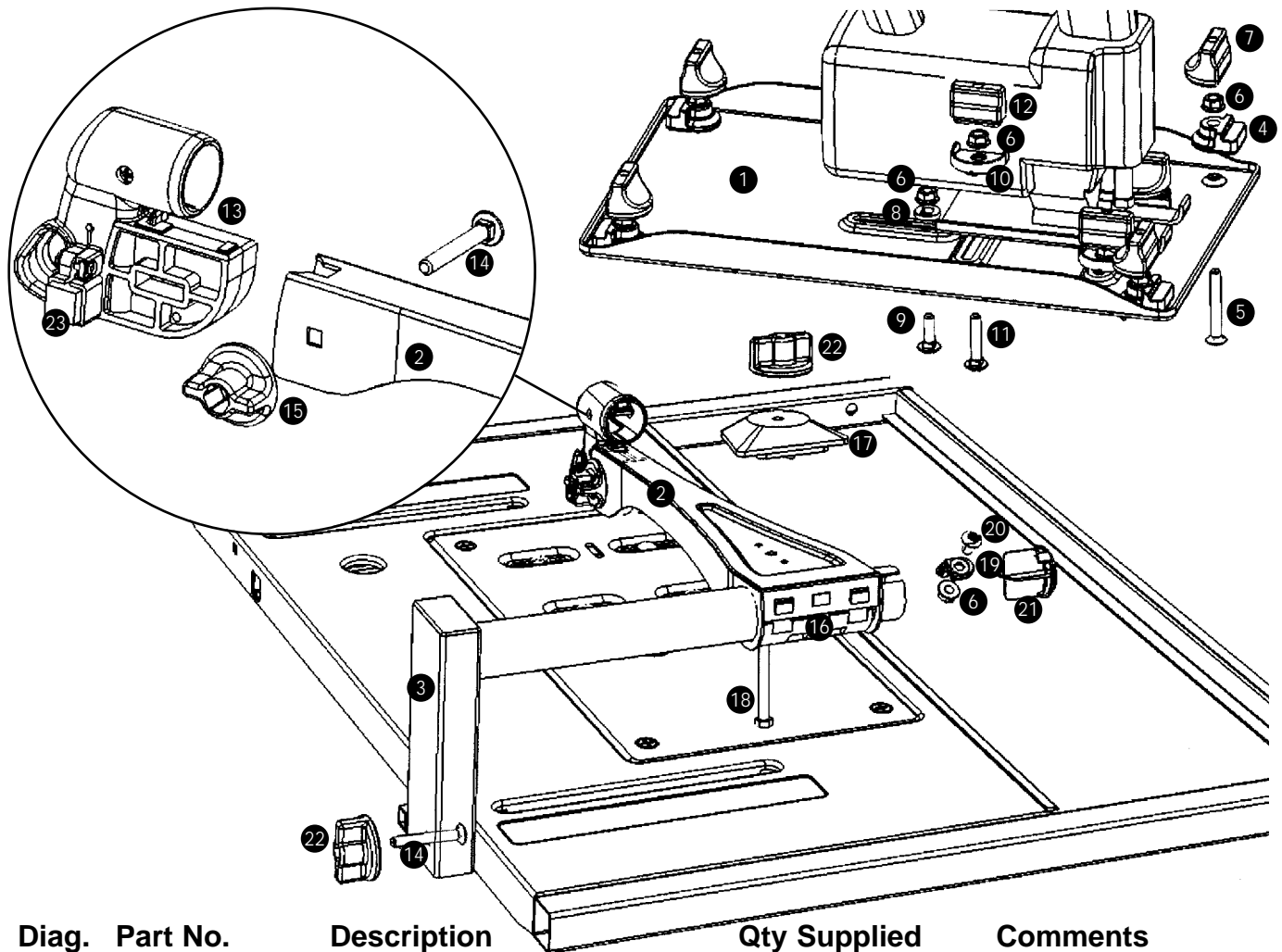

Diag. Ref.	Part No.	Description	Qty Supplied as Spare Part	Comments
-	PUA502	Packing Carton	1	
-	PUA504	Instruction Manual	1	
1	AJA302	Jigsaw Plate	1	
2	AJA326	Overhead Arm	1	
3	AJA324	Support Arm	1	Does not include pivot clamp
4 & 7	RTA394	Plate Tree	1	
8,10&12	CMA037	Saw clamp tree and nut assembly	1	
13	AJA327	Blade Guard	1	
15	AJA328	Small Round Knob with M6 Nut	1	
16	AJA318	Pivot Clamp	1	
17	AJA319	Bridge - Overhead clamp	1	
19	AJA323	Locator - Overhead arm	1	
21	AJA313	Tube Plug - 31.8mm ID	1	
22	CMA040	Large Round Knob with M6 Nut	1	
23	AJA321	Hawrdwood guide block (each)	1	
-	AJA303	Fastener Bag 1 (Jigsaw plate components)	1	
-	AJA311	Fastener Bag 2 (Support components)	1	
<b>Fasteners not supplied separately</b>				
5		M6 x 45 Countersunk Screw		
6		M6 Flange Nut		
9		M6 x 20 Coach Bolt		
11		M6 x 40 Coach Bolt		
14		M6 x 45 Coach Bolt		
18		M6 x 55 Coach Bolt		
20		M6 x 10 Hex Bolt		

## Specifications:

**Packed weight:** 2.8kg

**Paint:** Epoxy powder coat

**Pack Size:** 385 x 205 x 80mm

**Overhead Arm:** Telecom Gold

**Volume:** 0.0063m<sup>3</sup>

**Support Arm:** Charcoal

**Plate:** Silver